

# Alexer<sup>®</sup>

## Protective backing layer

Breathable and comfortable non-woven helps prevent leakage

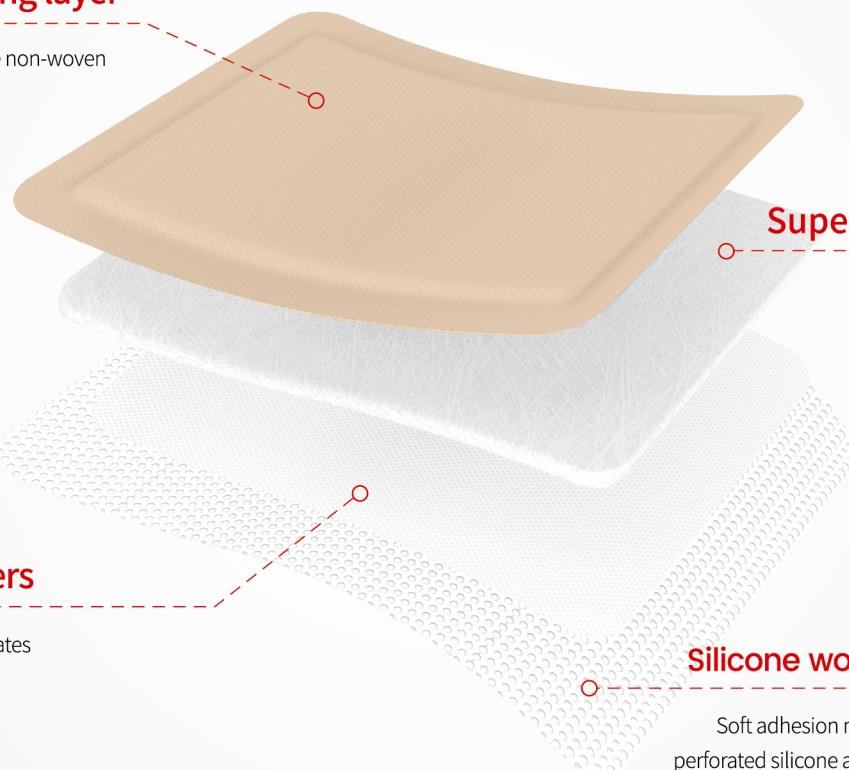

## Super absorbent core

Absorbs and holds up to 20times its own weight

## Distribution layers

Hold and transmit the exudates into absorbent layer

## Silicone wound contact layer

Soft adhesion more suitable for sensitive skin perforated silicone allows transmission of exudate into the absorbent layer quickly

# SUPER ABSORBENT DRESSING

◇ Silicone Adherent



## DESCRIPTION

Alexer® Super absorbent dressing-silicone adherent is indicated for management of moderately to heavily exuding wounds, including: leg ulcers, pressure ulcers, diabetic foot ulcers and dehisced surgical wounds.

## APPLICATIONS

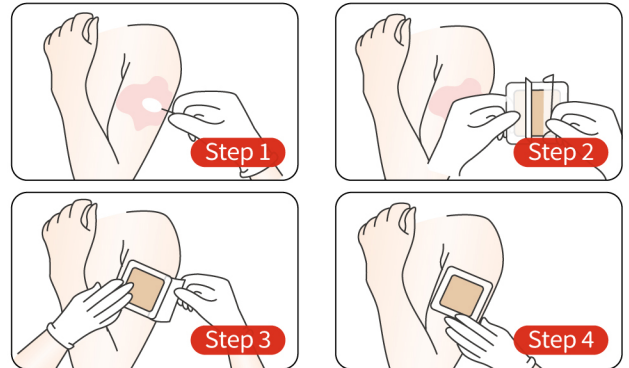

Ultra-absorbent pads(SAP) with silicone adhesive that is suitable for a wide range of acute and chronic exuding wounds.

Absorb the seepage and lock the liquid.

High wearing comfort due to excellent padding properties.

Silicone coated contact layer and border allows for repeated lifting and repositioning while enabling atraumatic removal.

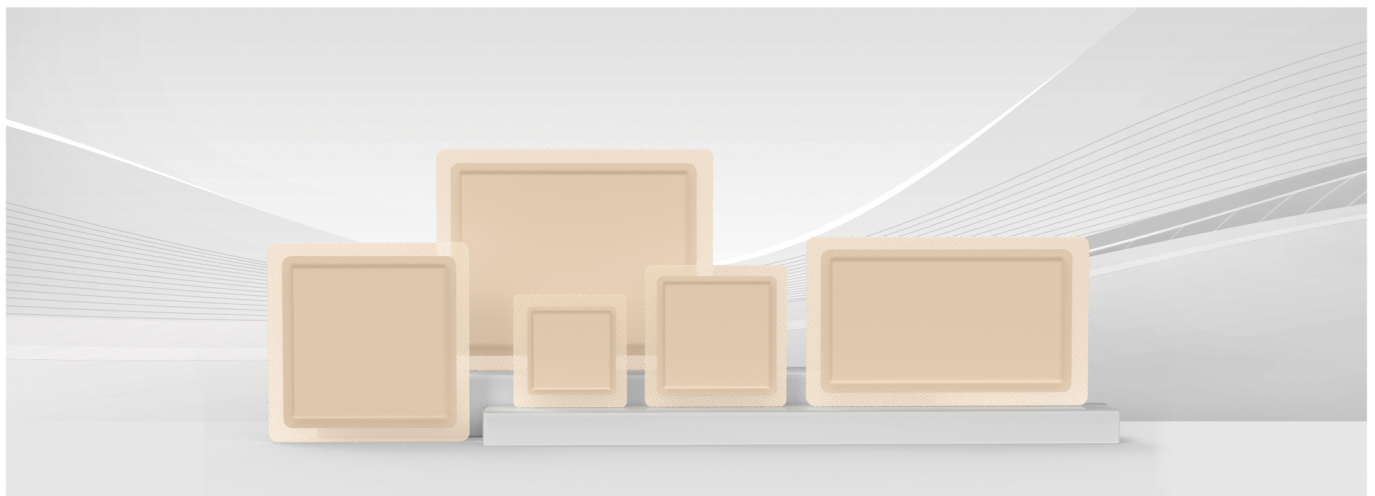

Type	Size	Package	Ref.No.
 <b>Square</b>	10X10cm	5pcs/bx,40bxes/ctn	S50013001
	12.5X12.5cm	5pcs/bx,40bxes/ctn	S50013002
	15X15cm	5pcs/bx,40bxes/ctn	S50013003
	10X20cm	5pcs/bx,40bxes/ctn	S50013004
	20X20cm	5pcs/bx,40bxes/ctn	S50013005